



# Preventative Maintenance Guide

## Dansensor MAP Check 3 Vacuum

Technical Support: 01223 492087  
 techsupport@tendringpacific.com

Dansensor Preventative Maintenance Guides help you to care more effectively for your equipment during the time between planned services.

For Safety Instructions, Trouble Shooting & Operation - please refer to the User Guide

### Cleaning and Maintenance

In addition to the Annual Service & Calibration, it is recommended to carry out the following maintenance checks at the interval times stated below.

#### Once a Week:

Sample Gas Filter and Fan Filters - Check and Replace (as required)

The sample gas filter (1) will be located under the packing machine attached onto the sample block. **During use of the device, dust, debris, and moisture may be sucked through the measuring system.** We recommend that the filter is regularly inspected and replaced when necessary. To replace the filter simply unscrew the connection fittings. If the filter is blocked, an error will appear on the display.

Clogged air inlet and outlet filters can lead to overheating of the device, therefore they should be replaced or cleaned regularly, especially when used in a dusty environment. To replace the filters, release the ventilation grill (1). If the grill does not come off easily, then use a screwdriver (2) to gently release it. The filter (3) is located inside the grill. Either change both parts (1,3), or clean out the filter if in a reusable condition. Do not remove the screws (4) from the inside grill, as they hold the fan in place.

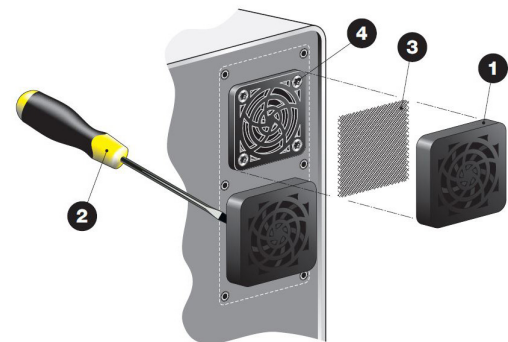
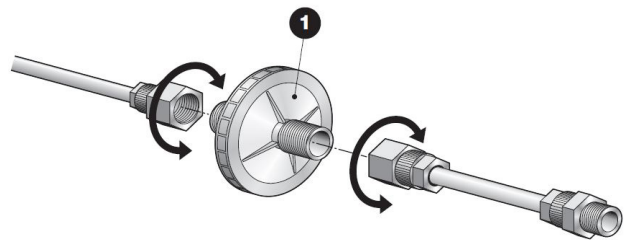

#### Once a Month:

Buffer Filter and Air Inlet Filter - Check and Replace (as required)

The MAP Check 3 Vacuum option with buffer sampling has a filter that can be replaced. This filter is replaced annually at service, but could require replacing. To replace, disconnect the gas inlet hose (1) from the push fit (2). Unscrew the push fit (2) and replace the filter (3). Connect push fit (2) and insert hose (1) again.

The air inlet filter can at times become visibly dirty and in some cases brake. To replace, unscrew the filter (1) and replace with new, then insert back into the unit while remembering to fit the gasket (2).

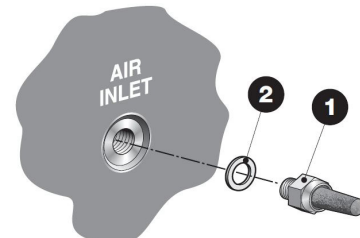
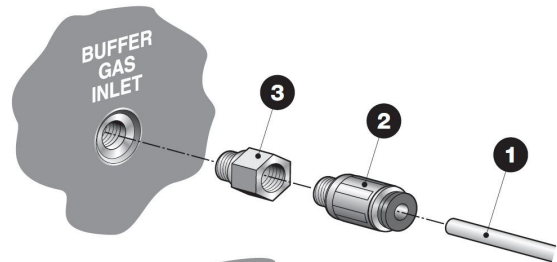

## Dansensor MAP Check 3 Vacuum Consumable Parts

Filter, sample gas 0.2µ  
 Multiplum filter, fan (10pcs)  
 Buffer filter, 5µm

Part No: 320722  
 Part No: 301093  
 Part No: 310629

Air inlet filter  
 Sampling kit, on-line, vacuum

Part No: 320749  
 Part No: 320723

To order consumables please contact Claire Duke on 01223 492086 or email [claire.duke@tendringpacific.com](mailto:claire.duke@tendringpacific.com)

