



Preventative Maintenance Guide

Dansensor MAP Mix Provectus

Technical Support: 01223 492087
techsupport@tendringpacific.com

Dansensor Preventative Maintenance Guides help you to care more effectively for your equipment during the time between planned services.

For Safety Instructions, Trouble Shooting & Operation - please refer to the User Guide

Cleaning and Maintenance

In addition to the Annual Service & Verification, it is recommended to carry out the following maintenance checks at the interval times stated below.

Once a Week:

Fan Filters - Check and Replace (as required)

Clogged air inlet and outlet filters can lead to overheating of the device. They should therefore be replaced, or cleaned regularly, especially when used in a dusty environment.

To replace the filters:

Release the ventilation grill (1). If the grill does not come off easily, then use a screwdriver (2) to gently release it.

The filter (3) is located inside the grill. Either change both parts (1 & 3), or clean out the filter if it is in a reusable condition. Do not remove the screws (4) from the inside of the grill, as they hold the fan in place.

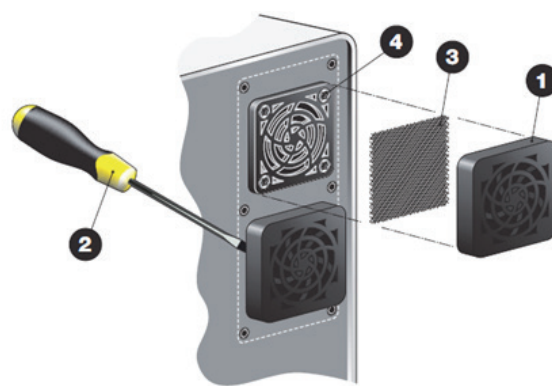

Once a Month:

Gas Inlet Filters - Check and Replace (as required)

Gas inlet filters are replaced during an annual service and calibration, but in extreme cases could need changing sooner, as a result of debris, or dirt, in the gas. There are two ways to replace the gas in filter.

1. The gas inlet filter (4) screws directly into the pipework going into the unit. Make sure that the washer (5) is attached onto the filter. In most cases the inlet filter will screw onto the 3-way pipe and in others, as shown, straight onto the unit. Remove the fittings going onto the inlet filter and then remove the filter from the unit, replace and attach all pipework and fittings back onto the filter.

2. A quick and easy way to change the gas inlet filters for the CO₂ and N₂ gases when being used alongside our regulators and 12mm flexi hosing.

The hose from the regulator into the unit is cut and the gas inlet filter, as shown, is attached onto both sides of the cut hose. If the unit already has a gas inlet filter attached onto the 12mm flexi hosing, then simply depressurise the hosing and remove and replace with a new kit.

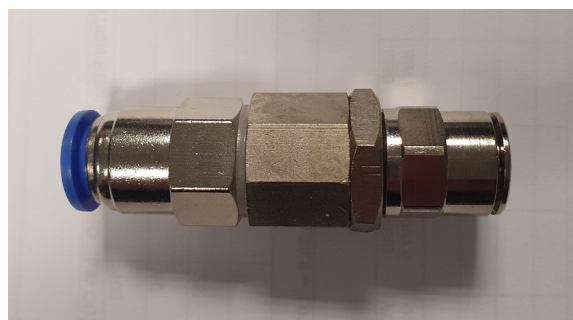
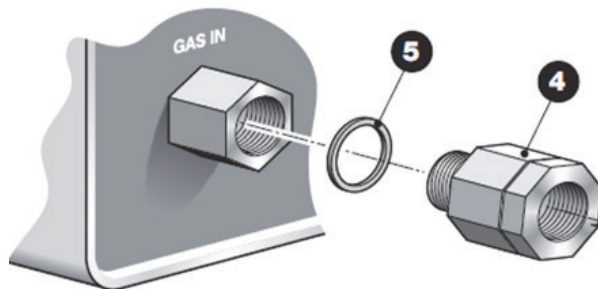

To order consumables please contact Claire Duke on 01223 492086 or email claire.duke@tendringpacific.com



Preventative Maintenance Guide

Dansensor MAP Mix Provectus

Technical Support: 01223 492087
techsupport@tendringpacific.com

Dansensor Preventative Maintenance Guides help you to care more effectively for your equipment during the time between planned services.

For Safety Instructions, Trouble Shooting & Operation - please refer to the User Guide

Dansensor MAP Mix Provectus Consumable Parts

Multiplum filter, fan (10pcs)

Part No: 301093

Gas Inlet Kit

Part No: Gasinkit

Multiplum filter, Gas in

Part No: 301092